

Kitchen

Performance Statement:	The kitchen space is designed to support ease of movement between fixed benches and to support easy adaptation.
Essential	No requirements.
Desirable	<ul style="list-style-type: none">a. The kitchen space should be designed to support ease of movement and adaptation with –<ul style="list-style-type: none">i. at least 1200mm clearance provided in front of fixed benches and appliances. See figures 19 and 19a; andii. slip resistant flooring.b. Where practicable, floor finishes should extend under kitchen cabinetry to enable cupboards to be moved without affecting the flooring.

This information was sourced from the national Livable Housing Design Guidelines produced by the National Dialogue on Universal Housing Design.

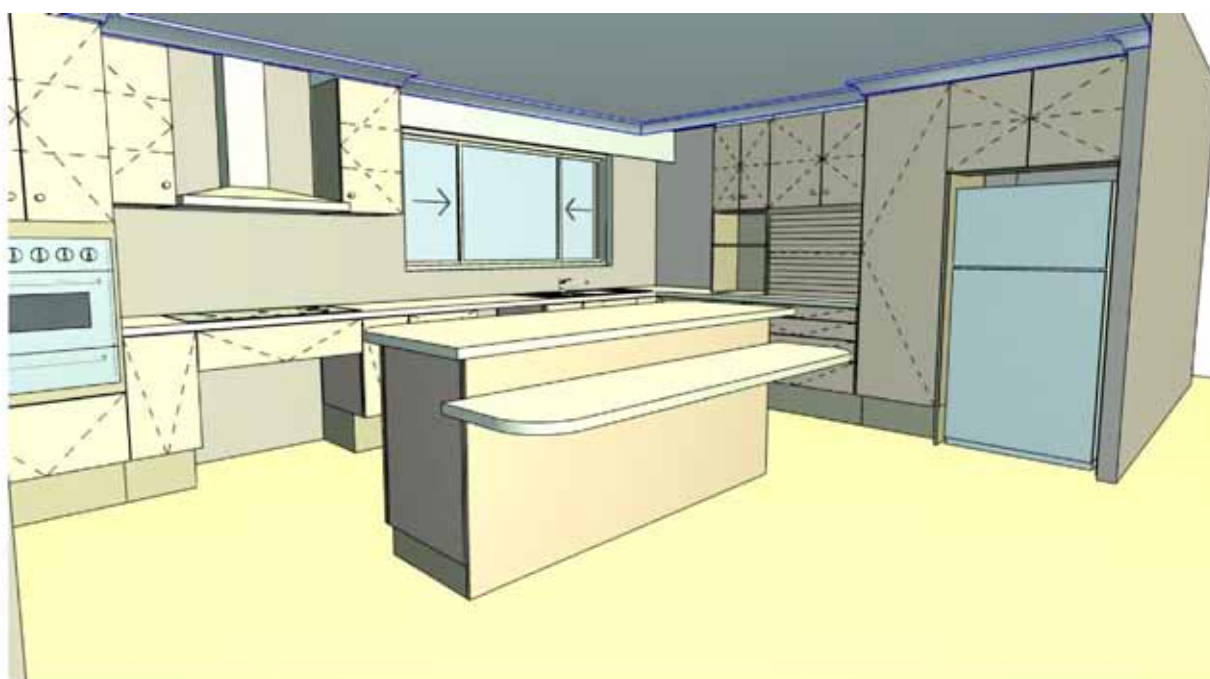

Figure 19. Kitchen perspective

This information was sourced from the national Livable Housing Design Guidelines produced by the National Dialogue on Universal Housing Design.

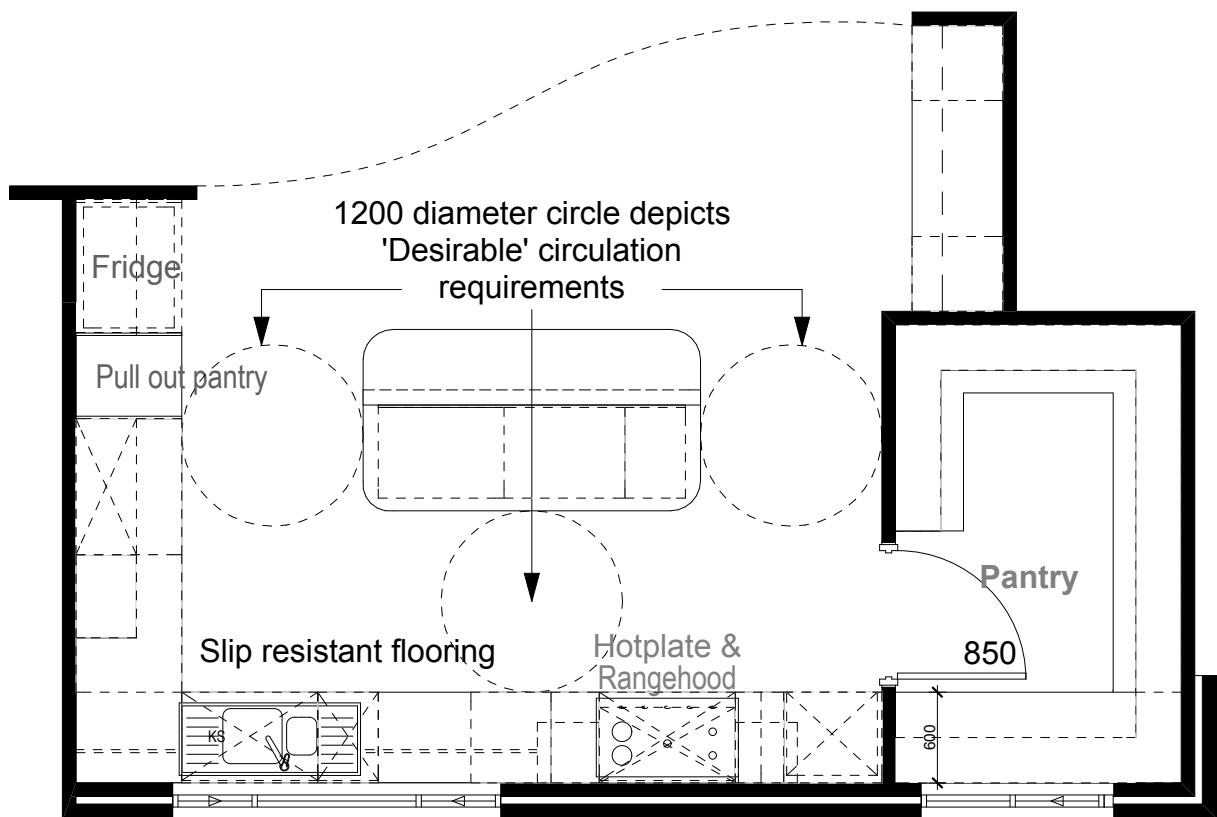

Figure 19a. Kitchen - Desirable

This information was sourced from the national Livable Housing Design Guidelines produced by the National Dialogue on Universal Housing Design.