

Laundry

Performance Statement:	The laundry space is designed to support ease of movement between fixed benches and to support easy adaptation.
Essential	No requirements.
Desirable	<ul style="list-style-type: none">a. The laundry space should be designed to support ease of movement and adaptation with -<ul style="list-style-type: none">i. at least 1200mm clearance provided in front of fixed benches and appliances. See figures 22 and 22a; andii. slip resistant flooring.b. Where practicable, floor finishes should extend under laundry cabinetry to enable cupboards to be moved without affecting the flooring.

This information was sourced from the national Livable Housing Design Guidelines produced by the National Dialogue on Universal Housing Design.

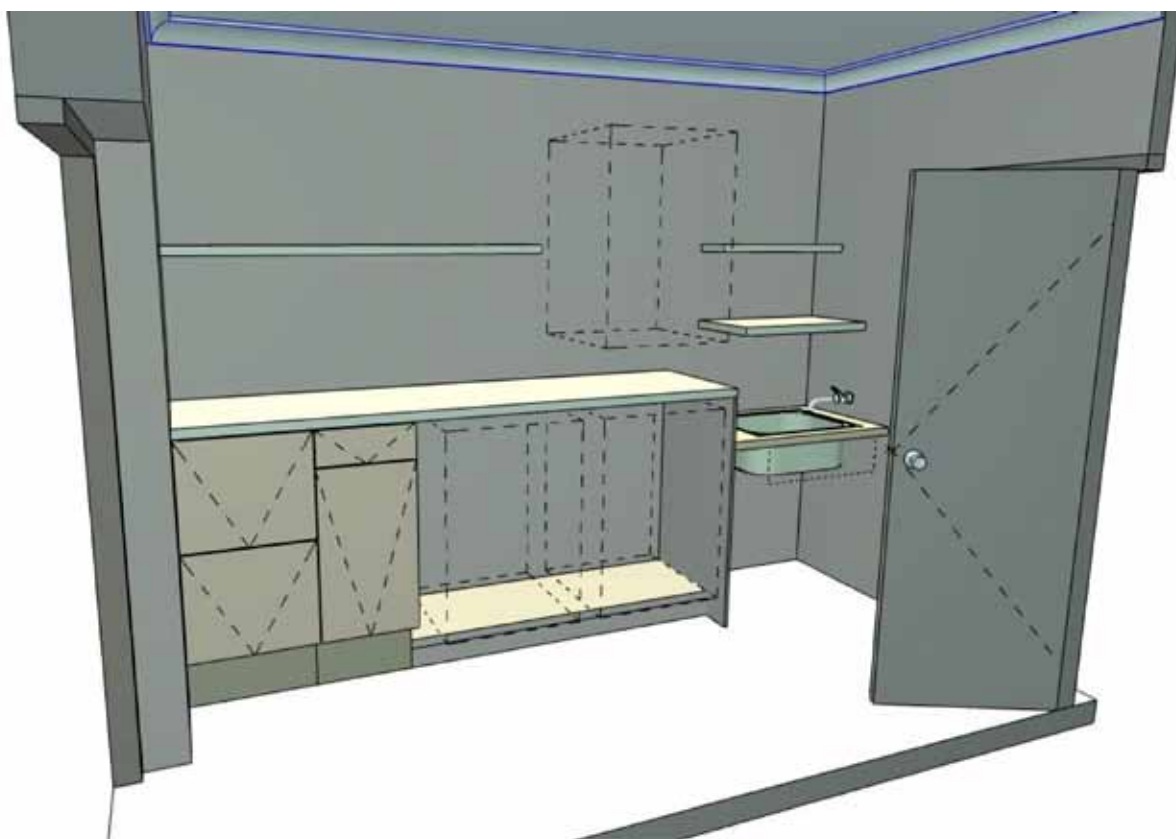

Figure 22. Laundry perspective

This information was sourced from the national Livable Housing Design Guidelines produced by the National Dialogue on Universal Housing Design.

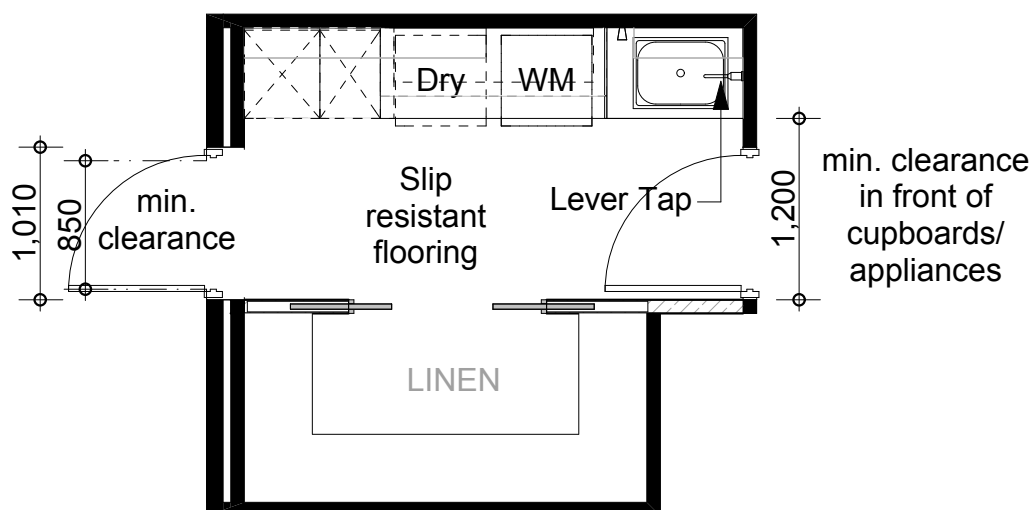

Figure 22a. Laundry floor plan

This information was sourced from the national Livable Housing Design Guidelines produced by the National Dialogue on Universal Housing Design.